



STRATHFIELD PARTNERS
REAL ESTATE AGENTS



Office 2/9 Rochester Street Homebush NSW

This office suite provides a fantastic opportunity to business owners looking to locate in the heart of Homebush - with great exposure and high traffic flow, this space is ideal for any number of businesses. The suite's immaculate location makes it easy for staff, customers and clients to access, with an abundance of on-street parking while Homebush train station is situated just moments away. A vast array of cafes, restaurants and shops are also within arm's reach.

- Simple yet versatile office space of 25.5sqm
- First floor overlooking Rochester Street
- Bathroom amenities, car-space included

Building Size : 25.5 sqm
View : <https://www.strathfieldpartners.com.au/lease/nsw/inner-west/homebush/commercial/offices/5962477>



Helen Chai
9704 0043



Fabrizio Pignataro
9704 0018

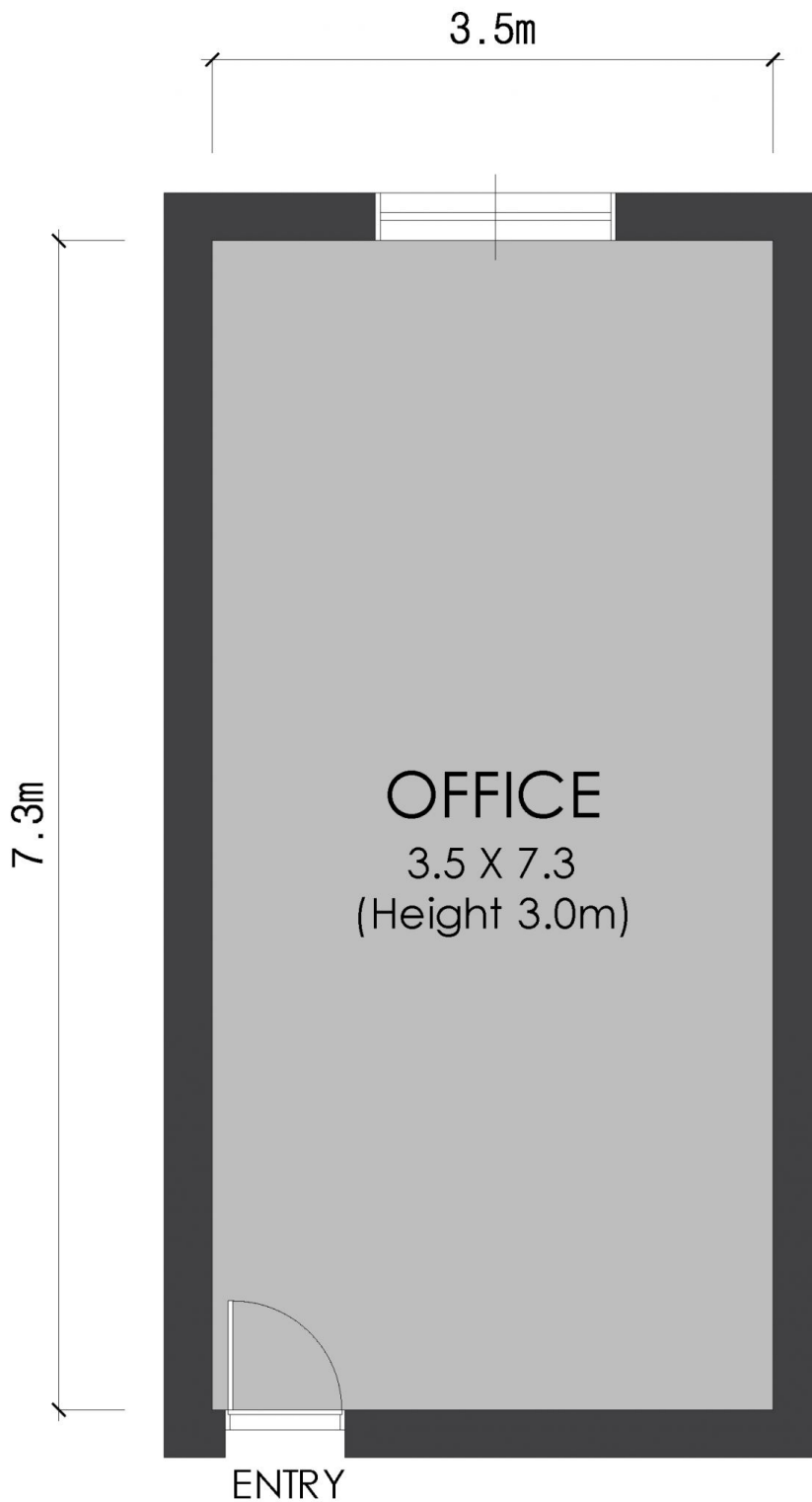

FLOOR PLAN

APPROX. AREA SIZE	
Internal area	25.5 sqm



STRATHFIELD PARTNERS
REAL ESTATE AGENTS

Suite 2/9 Rochester St, Homebush

WARNING: DISCLAIMER This information is not to be relied upon. It is strictly used for marketing and illustration purposes only. All measurements are approximate. Not to scale. No liability accepted. You must rely on your own inquiries and seek advice from your solicitor. Floor plan by cnkplan@cnkplan.com.au / www.cnkplan.com.au