



**STRATHFIELD PARTNERS**  
REAL ESTATE AGENTS



**Office 1A/12 Churchill Avenue Strathfield NSW**

Located in the heart of Strathfield is this double fronted office space, conveniently located in the Symond Arcade, located within Strathfield Plaza. This office comprises of 37 sqm, on the first floor in a security building, and among other professional businesses.

**Building Size** : 37 sqm  
**Land Size** : 37 sqm  
**View** : <https://www.strathfieldpartners.com.au/lease/nsw/inner-west/strathfield/commercial/offices/5962963>

**Outgoings Included in Rental Price**

- Close to transport.
- Security Building
- Modern Building
- Partitioned Office
- Flexible Term and Conditions
- Air Conditioning



**Fabrizio Pignataro**  
9704 0018



**Helen Chai**  
9704 0043

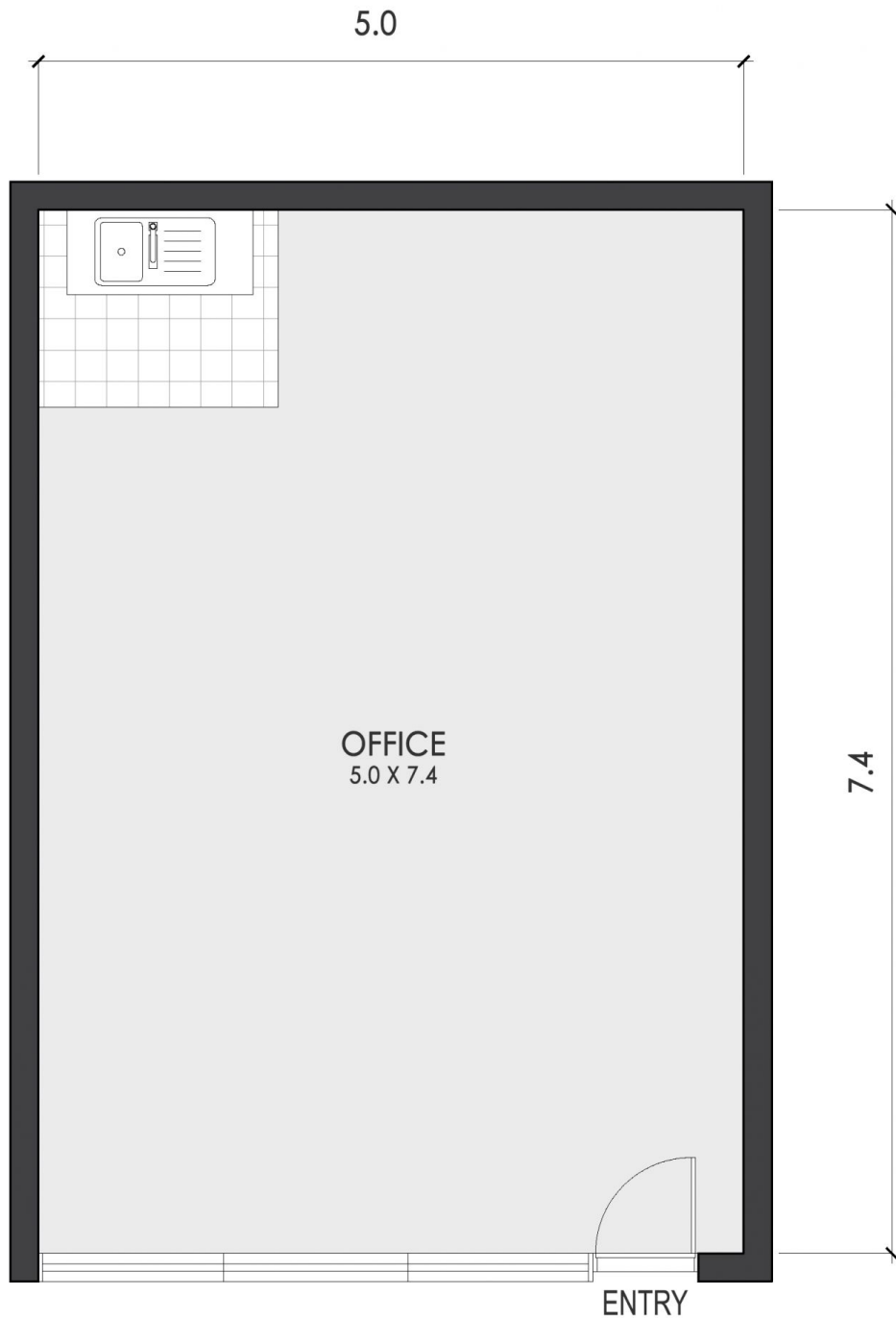

## FLOOR PLAN

APPROX. AREA SIZE

Internal area 37.0 sqm



**STRATHFIELD PARTNERS**  
REAL ESTATE AGENTS

# Suite 1A/12 Churchill Avenue, Strathfield

The floor plan is shown for view purposes only and is not part of any legal document. All measurements and figures are approximate and not to scale.  
Floor plan by CNK PLAN / [www.cnkplan.com.au](http://www.cnkplan.com.au)