



Office 10/58 The Boulevard Strathfield NSW

This modern office space is located amongst everything Strathfield has to offer, situated just a short stroll from Strathfield Plaza and its abundance of shops and cafes. Commuting is made easy as this office suite is positioned a mere stone's throw from Strathfield Railway Station, 2 minutes from the M4 and 15 minutes from the CBD.

This premises features:

- 2 secure parking spaces
- Air conditioning
- Part partitioned layout
- Area of 71m² (Approx.)
- Modern finishes

Building Size : 71 sqm

View : <https://www.strathfieldpartners.com.au/lease/nsw/inner-west/strathfield/commercial/offices/5963640>



Fabrizio Pignataro
9704 0018



Helen Chai
9704 0043

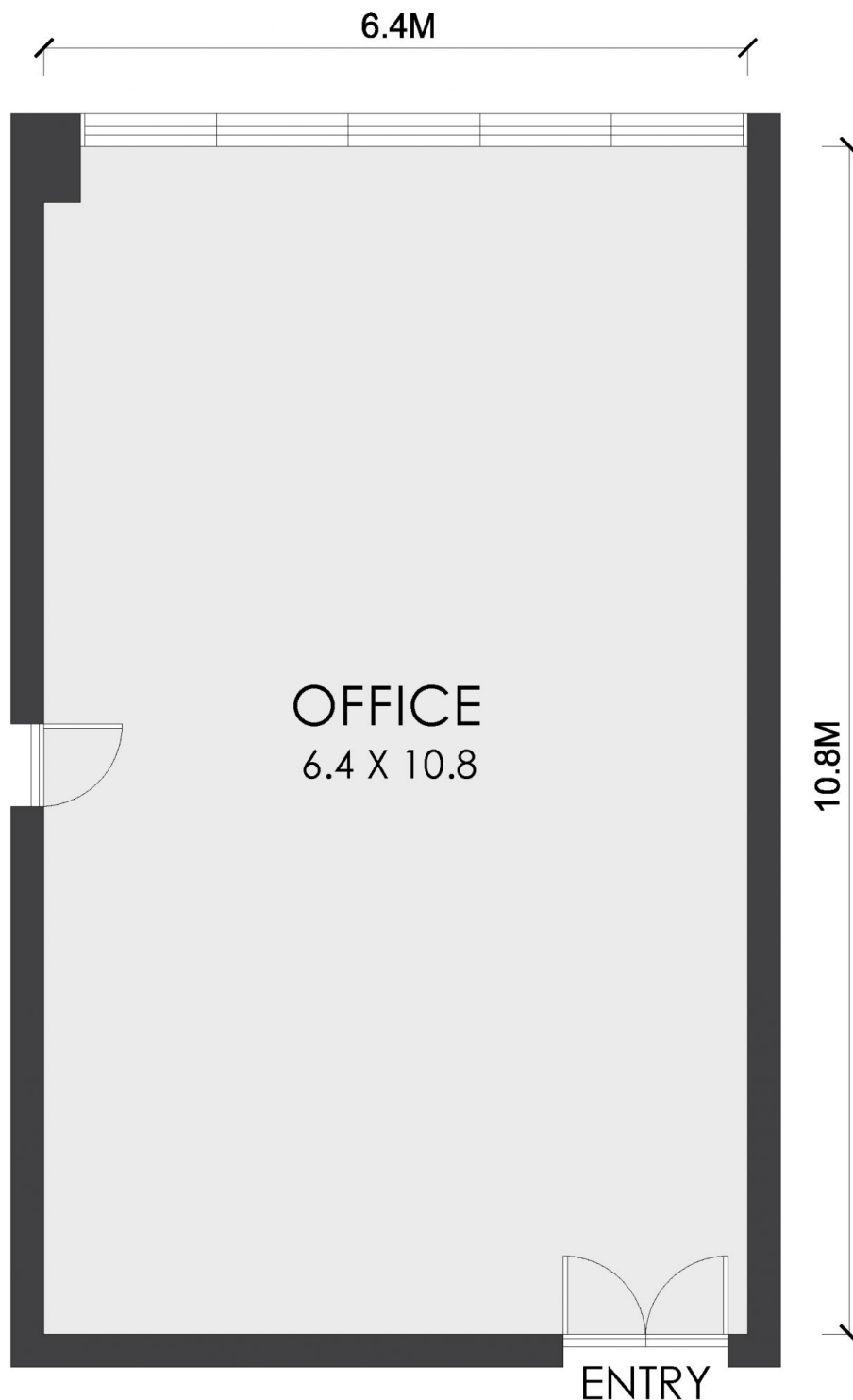

FLOOR PLAN



STRATHFIELD PARTNERS
REAL ESTATE AGENTS

APPROX. AREA SIZE

Internal area 69 sqm

Suite 10/58 The Boulevarde, Strathfield

WARNING: DISCLAIMER This information is not to be relied upon. It is strictly used for marketing and illustration purposes only. All measurements are approximate. Not to scale. No liability accepted. You must rely on your own inquiries and seek advice from your solicitor. Floor plan by cnkplan@cnkplan.com.au / www.cnkplan.com.au