

## Shop 11, Brodie Street Rydalmere NSW

11 Brodie Street, Rydalmere

Suitable for retail, office space or warehouse storage.

- Extensive Shopfront
- Located metres away from Rydalmere Station
- Parking close by
- High Ceilings
- Bathroom
- 187 sqm approx.

**Building Size** : 187 sqm  
**Land Size** : 187 sqm  
**View** : <https://www.strathfieldpartners.com.au/lease/nsw/parramatta/rydalmere/commercial/retail/5963738>



**Ali Tarawalle**  
0435 714 767

# FLOOR PLAN

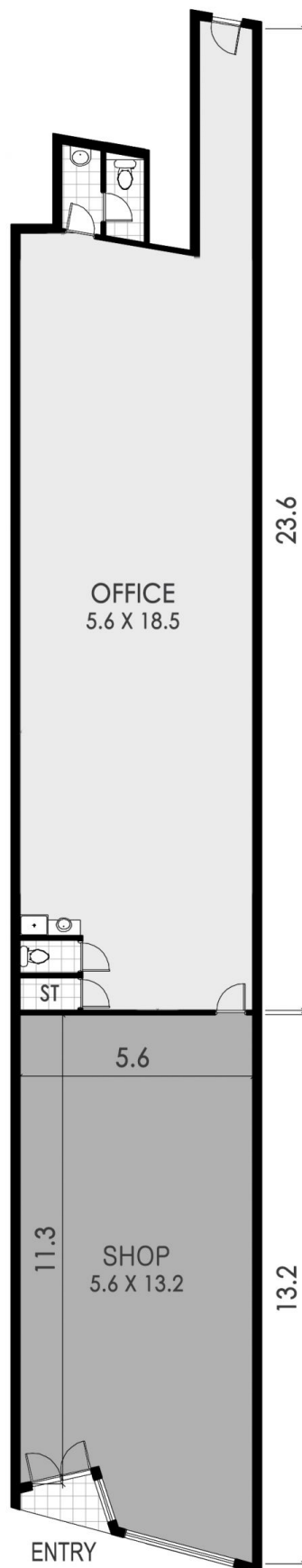

APPROX. AREA SIZE	
Internal area	187.4 sqm



**STRATHFIELD PARTNERS**  
REAL ESTATE AGENTS

## 11 Brodie Street, Rydalmere

The floor plan is shown for view purposes only and is not part of any legal document. All measurements and figures are approximate and not to scale.  
Floor plan by CNK PLAN / [www.cnkplan.com.au](http://www.cnkplan.com.au)