

### Shop 4.1/11A Bay Drive Meadowbank NSW

Strathfield Partners is proud to present this exciting opportunity in Meadowbank's Village Plaza. A total of 91sqm is available in this fantastic, well-positioned shop which is located just next to the Centre's carpark entrance allowing for exceptional foot traffic and exposure to customers. This space is ideal for a diverse range of businesses - the pre-existing fit-out is also available.

- Incredible location on the Centre's ground floor
- 90sqm of versatile space
- Incredible exposure in a highly energetic and dynamic shopping centre

**Type** : Retail  
**Building Size** : 91.1 sqm  
**View** : <https://www.strathfieldpartners.com.au/lease/nsw/northern-suburbs/meadowbank/commercial/retail/5964167>



**Sophy Kim**  
9763 2277



**Fabrizio Pignataro**  
9704 0018

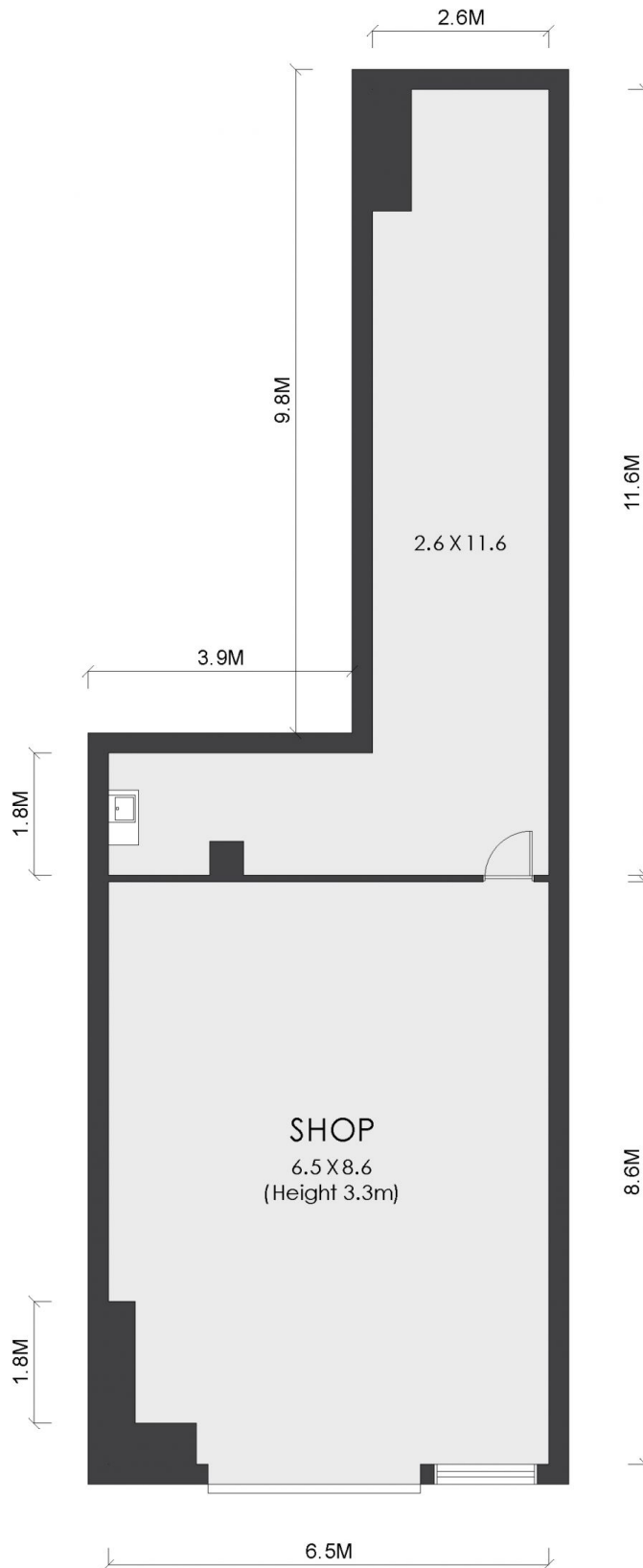

## FLOOR PLAN

### APPROX. AREA SIZE

Internal area 91.1 sqm



STRATHFIELD PARTNERS  
REAL ESTATE AGENTS

## Shop 4.1/11A Bay Drive, Meadowbank

**WARNING: DISCLAIMER** This information is not to be relied upon. It is strictly used for marketing and illustration purposes only. All measurements are approximate. Not to scale. No liability accepted. You must rely on your own inquiries and seek advice from your solicitor. Floor plan by [cnkplan@cnkplan.com.au](mailto:cnkplan@cnkplan.com.au) / [www.cnkplan.com.au](http://www.cnkplan.com.au)