



STRATHFIELD PARTNERS
REAL ESTATE AGENTS



Shop 6.8/11A Bay Drive Meadowbank NSW

Strathfield Partners is proud to present this sensational opportunity in Meadowbank's Village Plaza. This spacious 150sqm retail space is now available, positioned advantageously across from one of the centre's main points of entry. Suitable for a diverse range of business types, the shop is ideal for business owners looking to thrive in a prosperous environment.

- Fantastic top floor location
- Rear access to the Centre's loading dock
- Incredible exposure in a highly energetic and dynamic shopping centre

Building Size : 150 sqm
View : <https://www.strathfieldpartners.com.au/lease/nsw/northern-suburbs/meadowbank/commercial/retail/5964168>



Sophy Kim
9763 2277



Fabrizio Pignataro
9704 0018

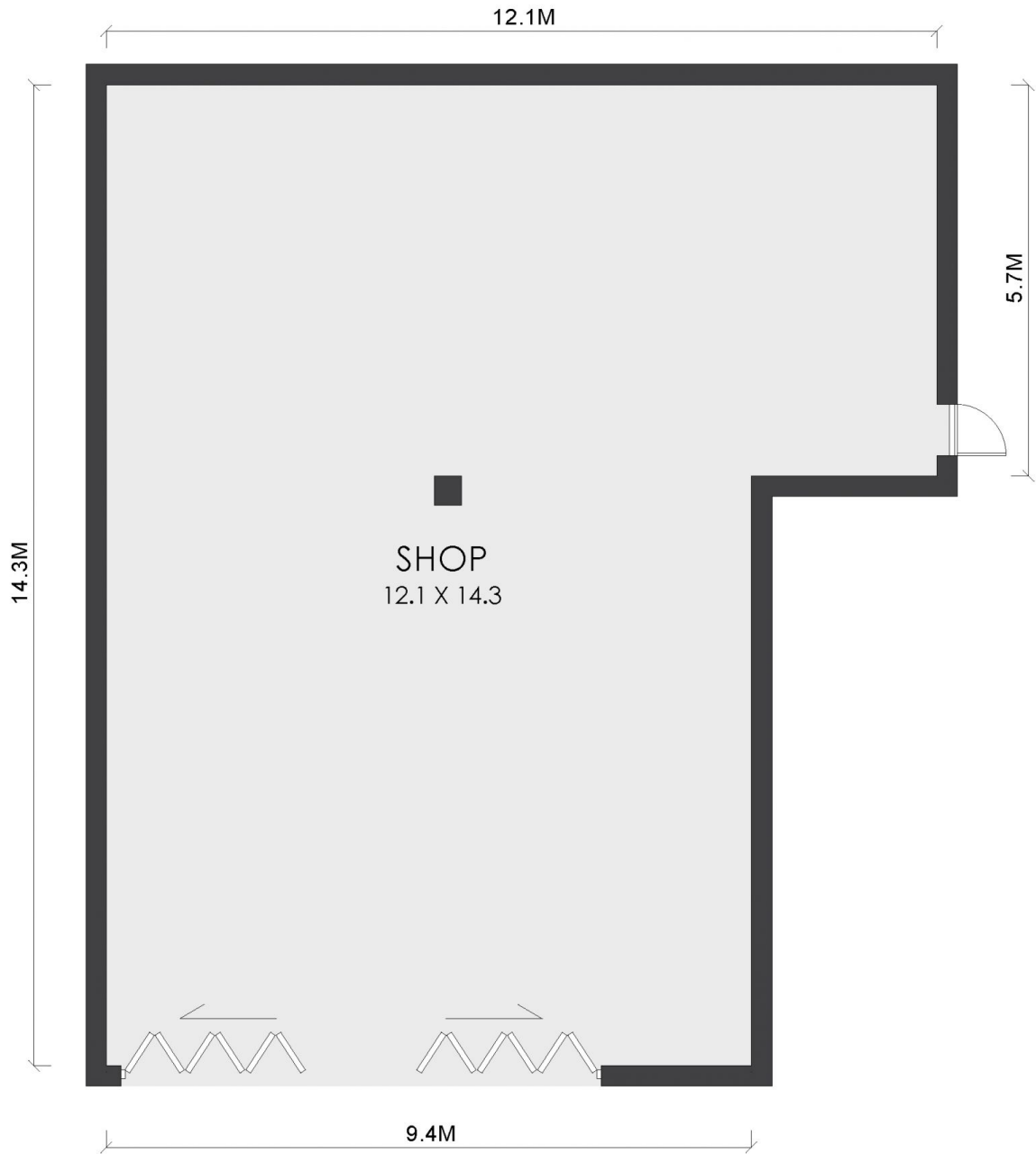

FLOOR PLAN

APPROX. AREA SIZE	
Internal area	150 sqm



STRATHFIELD PARTNERS
REAL ESTATE AGENTS

6.8/11A Bay Drive, Meadowbank

WARNING: DISCLAIMER This information is not to be relied upon. It is strictly used for marketing and illustration purposes only. All measurements are approximate. Not to scale. No liability accepted. You must rely on your own inquiries and seek advice from your solicitor. Floor plan by cnkplan@cnkplan.com.au / www.cnkplan.com.au