

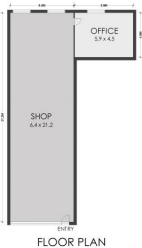

STRATHFIELD PARTNERS
REAL ESTATE AGENTS



FLOOR PLAN

F18/273 Fowler Road, Illawong

G18/273 Fowler Road Illawong NSW

Get the chance to be part of Illawong Village, located on the shores of the Georges River in the picturesque Sutherland Shire. With the ideal combination of the shop front and an office, this is an ideal space for business owners.

- * Approx area size of 163sqm
- * Expansive shop area 6.4m x 21.2 m
- * Additional extra private office area of 5.9mx 4.5m
- * Ground floor
- * Showcase your business in Illawong Village, a convenient upmarket shopping experience

Building Size : 163 sqm
View : <https://www.strathfieldpartners.com.au/lease/nsw/sutherland/illawong/commercial/retail/5964209>



Helen Chai
9704 0043



Fabrizio Pignataro
9704 0018

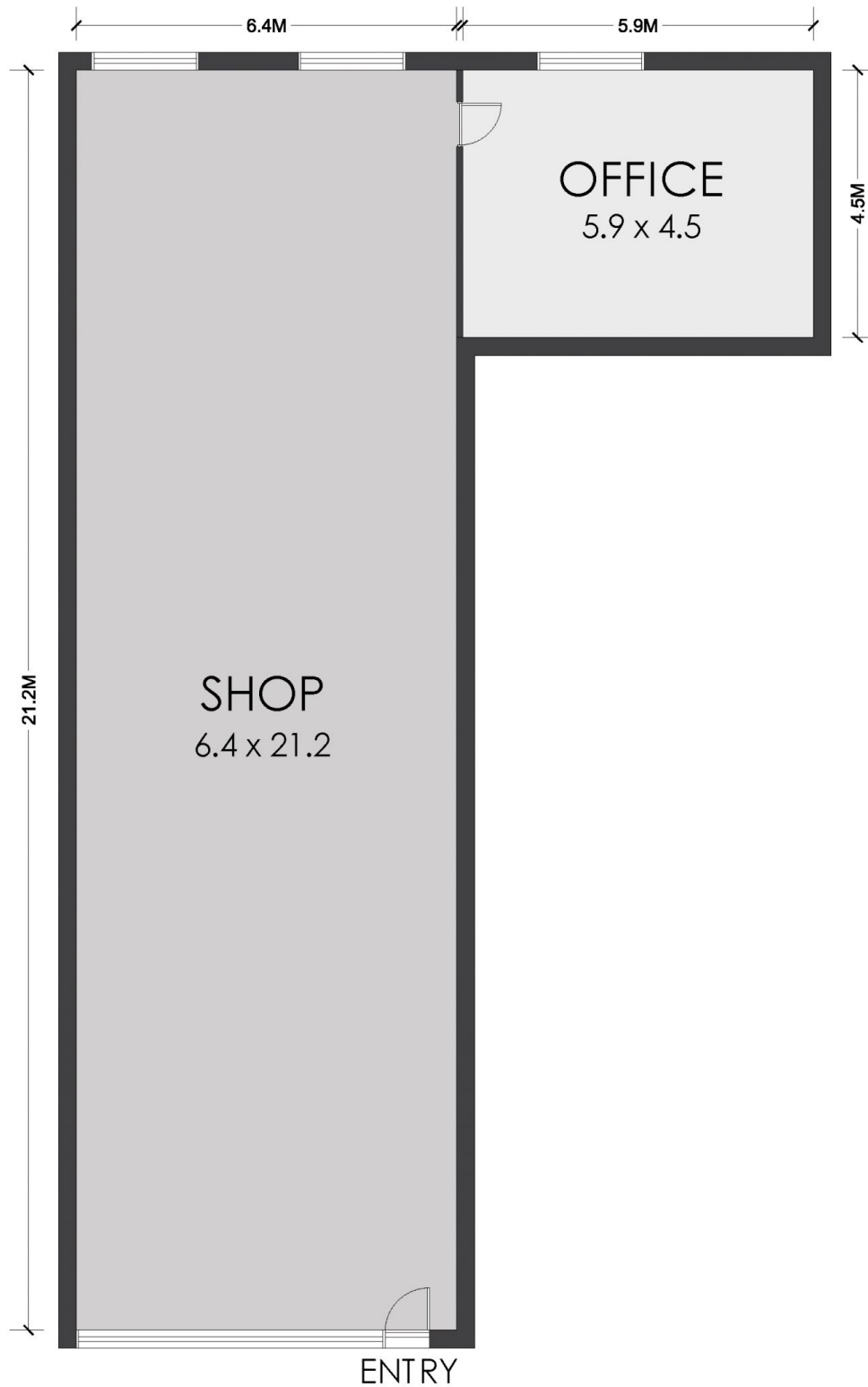

FLOOR PLAN

APPROX. AREA SIZE	
Internal area	163sqm



STRATHFIELD PARTNERS
REAL ESTATE AGENTS

F18/273 Fowler Road, Illawong

WARNING: DISCLAIMER This information is not to be relied upon. It is strictly used for marketing and illustration purposes only. All measurements are approximate. Not to scale. No liability accepted. You must rely on your own inquiries and seek advice from your solicitor. Floor plan by cnkplan@cnkplan.com.au / www.cnkplan.com.au