



Shop 5, Brodie Street Rydalmere NSW

Located in the heart of Rydalmere, opposite Rydalmere Train Station and amenities this prime commercial property comprises five (5) retail shops

- * Approx. 86sqm including bathroom inside of shop.
- * Suit many uses; Office or Retail
- * Bargain rental price

Building Size : 86 sqm
View : <https://www.strathfieldpartners.com.au/lease/nsw/parramatta/rydalmere/commercial/retail/5964248>



Helen Chai
9704 0043



Fabrizio Pignataro
9704 0018

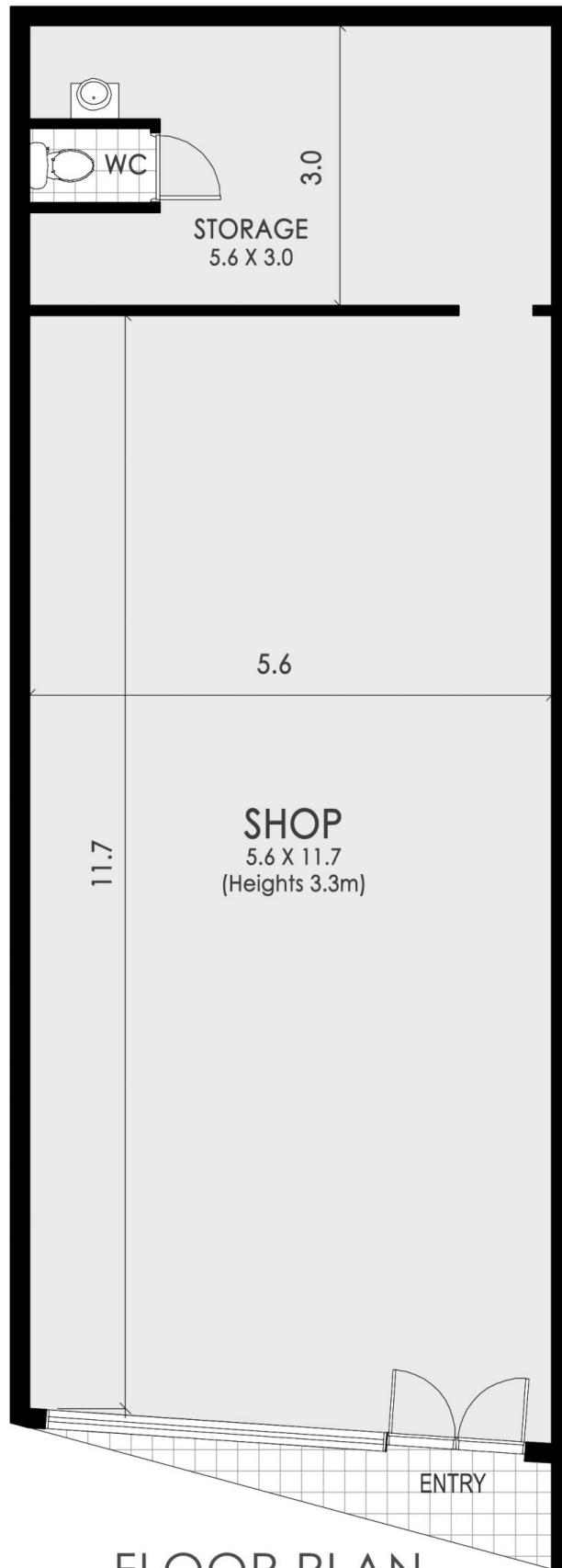

FLOOR PLAN

APPROX. AREA SIZE	
Internal area	86.1 sqm



STRATHFIELD PARTNERS
REAL ESTATE AGENTS

5 Brodie Street, Rydalmere

WARNING: DISCLAIMER This information is not to be relied upon. It is strictly used for marketing and illustration purposes only. All measurements are approximate. Not to scale. No liability accepted. You must rely on your own inquiries and seek advice from your solicitor. Floor plan by cnkplan@cnkplan.com.au/ www.cnkplan.com.au