



STRATHFIELD PARTNERS
REAL ESTATE AGENTS



155-157 Parramatta Road Five Dock NSW

Now available is this stunning showroom and car-yard on Parramatta Road, Five Dock, an incredibly-positioned commercial space on Sydney's busiest road. With a total of 9 internal offices plus kitchenette and bathroom facilities in this showroom's generous internal area, it is a highly versatile, fully secured space. The premises experience incredible exposure as a result of the tens of thousands of cars that drive past each day, with main access from Parramatta Road and rear access from Spencer Street.

- Prominently located on Parramatta Road
- Exposure to 67,000 approx. cars daily
- Dual driveway access
- Approx. 1,145sqm total area
- Approx. 539sqm internal area
- Air-conditioned office/showroom amenities
- Easy access to City West Link, M4 Motorway,

Building Size : 1145 sqm
View : <https://www.strathfieldpartners.com.au/ease/nsw/inner-west/five-dock/commercial/showroomsbulky-goods/5964251>



Helen Chai
9704 0043



Fabrizio Pignataro
9704 0018

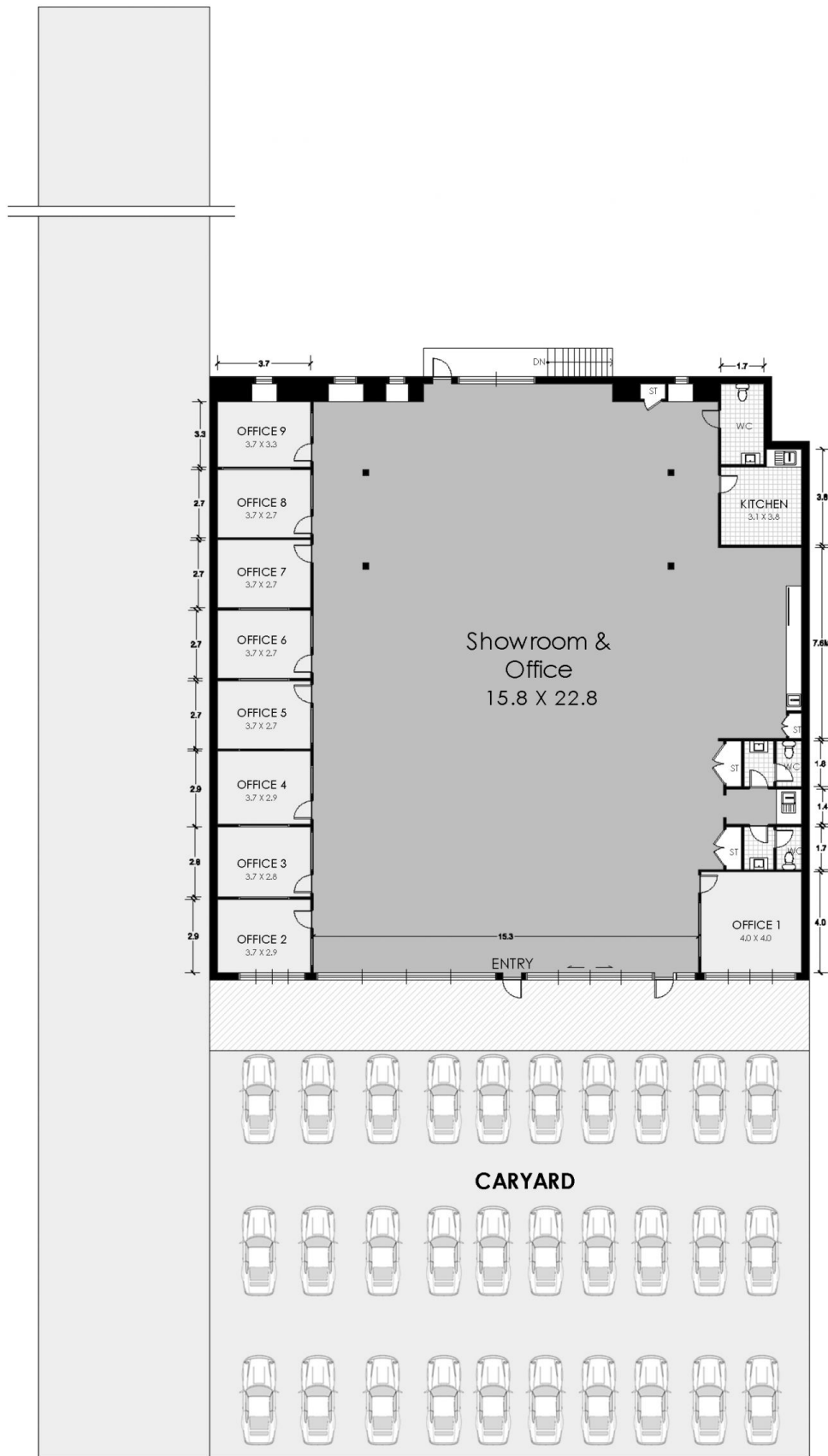

DRIVEWAY

FLOOR PLAN

APPROX. AREA SIZE

Internal

539 sqm



157 Parramatta Road, Five Dock

WARNING: DISCLAIMER This information is not to be relied upon. It is strictly used for marketing and illustration purposes only. All measurements are approximate. Not to scale. No liability accepted. You must rely on your own inquiries and seek advice from your solicitor. Floor plan by cnkplan@cnkplan.com.au / www.cnkplan.com.au