



G9/273 Fowler Road Illawong NSW

45.5sqm space in Illawong Village corner location, this space is ideal for retail, and showroom. Located at the ground centre floor, don't miss out an inspection!

- * Area approximately 45.5sqm
- * Double side window
- * Corner location
- * Spacious shop area
- * Be part of Illawong Village community, located at the banks of the Georges and Woronora Rivers

Building Size : 45.5 sqm
View : <https://www.strathfieldpartners.com.au/lease/nsw/sutherland/illawong/commercial/retail/5964284>



Helen Chai
9704 0043

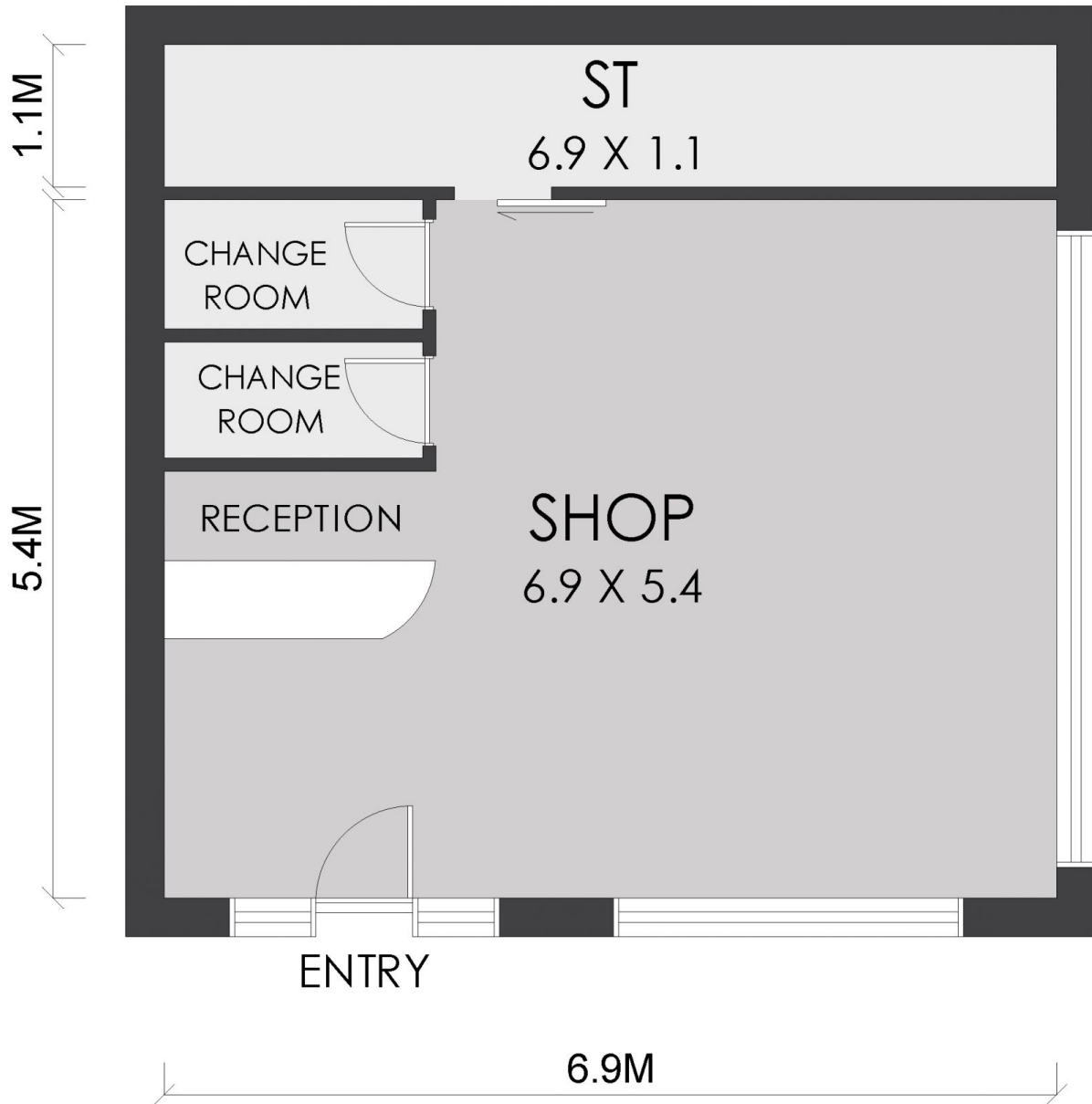

FLOOR PLAN



STRATHFIELD PARTNERS
REAL ESTATE AGENTS

APPROX. AREA SIZE

Internal area 45.5 sqm

G9/273 Fowler Road, Illawong

WARNING: DISCLAIMER This information is not to be relied upon. It is strictly used for marketing and illustration purposes only. All measurements are approximate. Not to scale. No liability accepted. You must rely on your own inquiries and seek advice from your solicitor. Floor plan by cnkplan@cnkplan.com.au / www.cnkplan.com.au