



STRATHFIELD PARTNERS
REAL ESTATE AGENTS



Shop 1/19 Burwood Road Burwood NSW

Just listed is this breathtaking and abundantly-spaced shopfront/office suite on Burwood Rd, Burwood, boasting a beautiful, multifaceted, dual-level layout that is ready to be occupied by your business. This truly is a top quality commercial space located in a central part of Sydney, a rare opportunity that is not to be missed. Featuring three car-spaces as well as two storage cages in the building's highly secure underground carpark, the premises are easily accessible from any part of Sydney, assisted by close proximity to Burwood train station.

- Two generously-sized internal levels including kitchen area and bathrooms
- Highly versatile layout to tailor the needs of your business
- Exceptionally positioned just 12km from Sydney's CBD

Building Size : 201 sqm
View : <https://www.strathfieldpartners.com.au/lease/nsw/inner-west/burwood/commercial/retail/5964404>



Helen Chai
9704 0043



Cornelia Day
0410 653 374

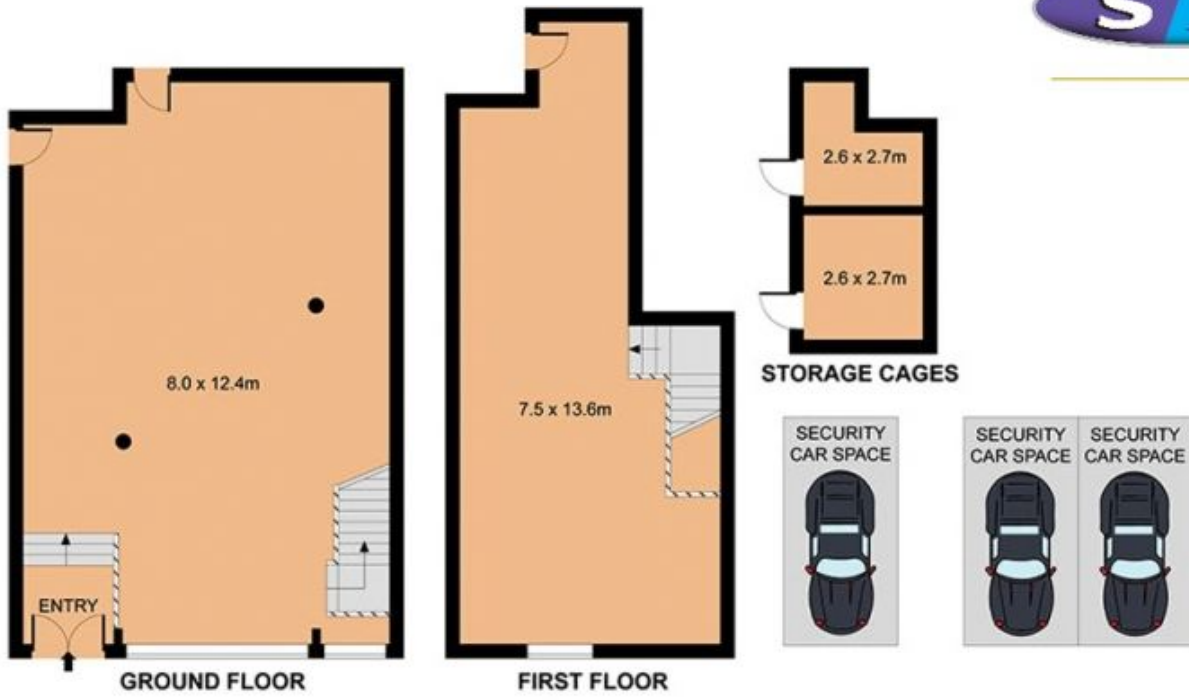

SHOP 1/19 BURWOOD ROAD, BURWOOD