



Shop 3/2 Walker Street Rhodes NSW

Fresh to the market is this superbly-situated shopfront directly across from Rhodes train station - a bustling, high-energy locale with heavy foot traffic throughout every hour of the day and every day of the week. With a generous 71.7sqm layout and separate kitchen and dining area, this space is ideal for restaurant-owners looking to thrive within a modern and highly sought-after area. Such a phenomenally-positioned retail space will not be on the market for long, please enquire today!

- Amazing location in one of Sydney's most promising suburbs
- High volume of customers throughout the entire day
- Spacious layout with no pre-existing fitout to allow you to construct your business the way you like

Building Size : 71.7 sqm
View : <https://www.strathfieldpartners.com.au/lease/nsw/inner-west/rhodes/commercial/retail/5964574>



Helen Chai
9704 0043



Fabrizio Pignataro
9704 0018

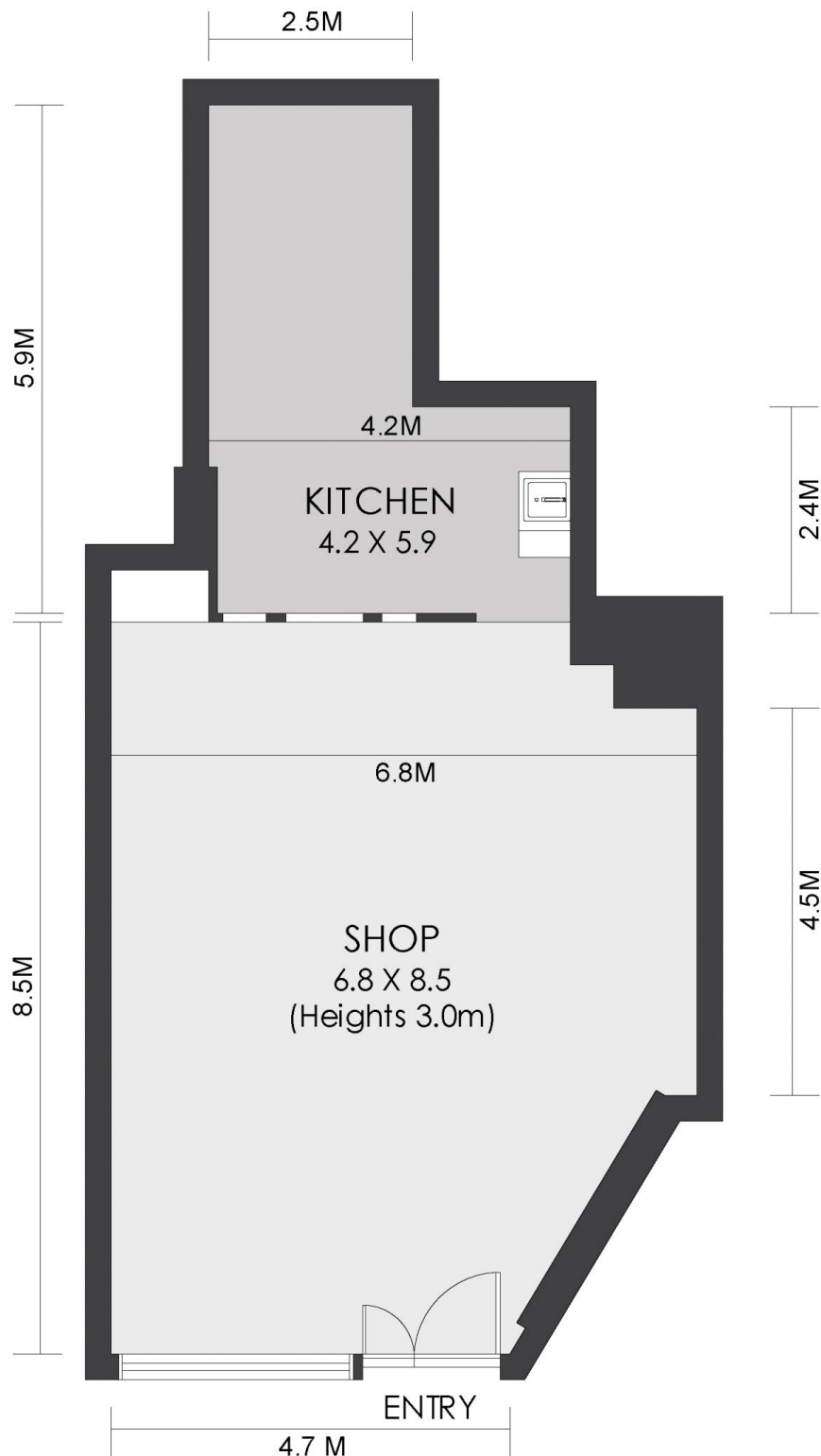

FLOOR PLAN



STRATHFIELD PARTNERS
REAL ESTATE AGENTS

APPROX. AREA SIZE

Internal area 71.7 sqm

Shop 3/2 Walker Street, Rhodes

WARNING: DISCLAIMER This information is not to be relied upon. It is strictly used for marketing and illustration purposes only. All measurements are approximate. Not to scale. No liability accepted. You must rely on your own inquiries and seek advice from your solicitor. Floor plan by cnkplan@cnkplan.com.au / www.cnkplan.com.au