



Level 1/11/12 Churchill Avenue Strathfield NSW

Located in the heart of Strathfield is small scale office conveniently located in the Symond Arcade, located within Strathfield Plaza.

This modern office comprises of 18.4sqm, on the first floor in a security building, and among other professional businesses.

Price Includes Outgoings

- Security Building
- Flexible Term and Conditions
- Modern Office
- Air Conditioning
- Close to Shops
- Close to Transport
- Close to Schools

Building Size : 18.4 sqm

View : <https://www.strathfieldpartners.com.au/lease/nsw/inner-west/strathfield/commercial/offices/5964630>



Fabrizio Pignataro
9704 0018



Helen Chai
9704 0043

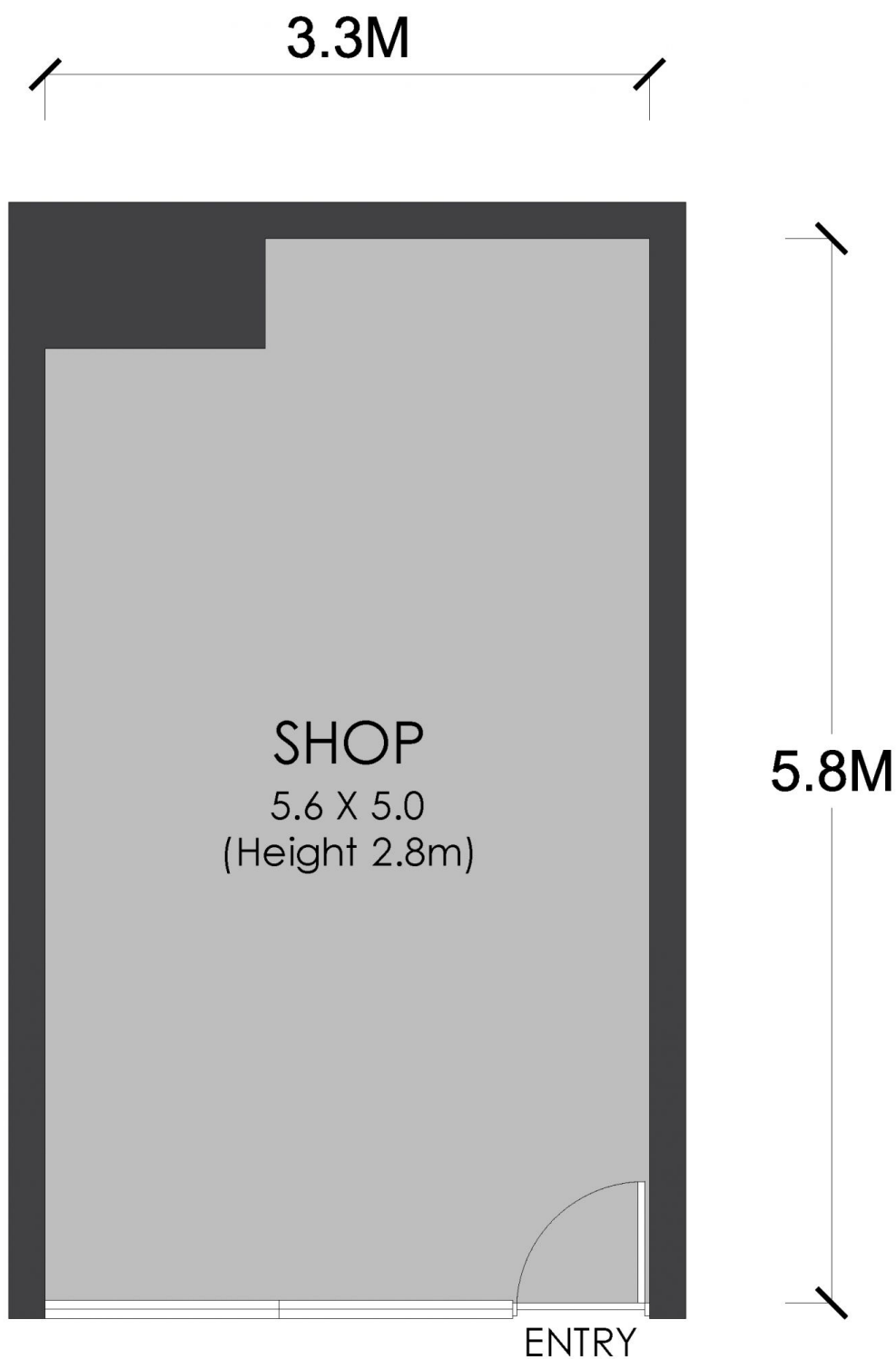

FLOOR PLAN



STRATHFIELD PARTNERS
REAL ESTATE AGENTS

Suite 11/12 Churchill Avenue, Strathfield

APPROX. AREA SIZE

Internal area 18.4 sqm

WARNING: DISCLAIMER This information is not to be relied upon. It is strictly used for marketing and illustration purposes only. All measurements are approximate. Not to scale. No liability accepted. You must rely on your own inquiries and seek advice from your solicitor. Floor plan by cnkplan@cnkplan.com.au / www.cnkplan.com.au