



### 39 Rosedale Avenue Greenacre NSW

Situated just off Brunker Road and within close proximity to Rookwood Road and The Hume Highway.

- \* Building Area - 318m<sup>2</sup>
- \* Land Area - 512m<sup>2</sup>
- \* Older style freestanding building
- \* Clear span factory with 3 phase power
- \* Security gated premises
- \* Zoned IN1 - General Industrial
- \* Roller Doors: 2 x Roller Doors (1 with side access)

**Building Size** : 318 sqm  
**Land Size** : 512 sqm  
**View** : <https://www.strathfieldpartners.com.au/lease/nsw/canterburybankstown/greenacre/commercial/industrial/6462985>



**Helen Chai**  
9704 0043



**Cornelia Day**  
0410 653 374

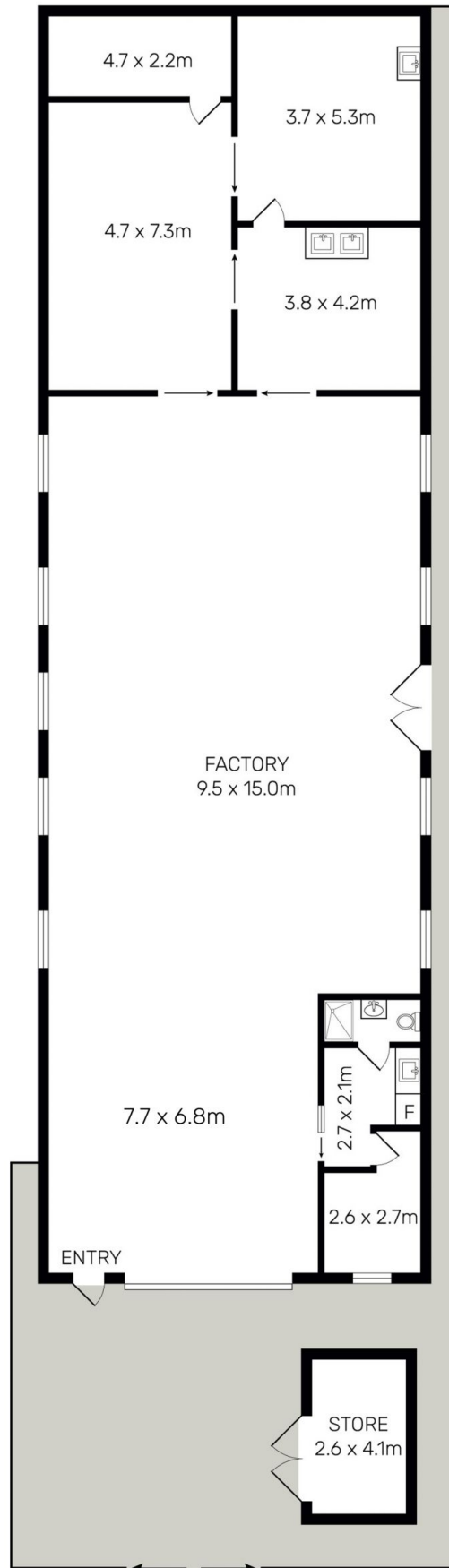

**STRATHFIELD PARTNERS**  
REAL ESTATE AGENTS

39 Rosedale Avenue, Greenacre



Dimensions are approximate. All information contained is gathered from sources we believe to be reliable. However, we cannot guarantee its accuracy and interested party should rely on their own enquires.

(02) 9763 2277