





1395 Canterbury Road Punchbowl NSW

3  1  2 

SOLD by Gavin Sanna

Sitting on a huge 1,012m2 block of land, this exceptional opportunity rarely comes along.

The renovated 3 bedroom, double brick home has a spacious living room, separate dining area and modern kitchen with gas cook top, Stainless steel appliances, dishwasher and ducted rangehood.

With its wide driveway to the lock up garage and enormous rear yard and easy access to M5 motorway, walk to school, shops and station, the solid home can be further extended or developed with the land and location having huge potential as development site (STCA).

Price : \$ 1,300,000
Land Size : 1012 sqm
View : <https://www.strathfieldpartners.com.au/sale/nsw/canterburybankstown/punchbowl/residential/house/6669359>



Gavin Sanna
02 9704 0027



FLOOR PLAN

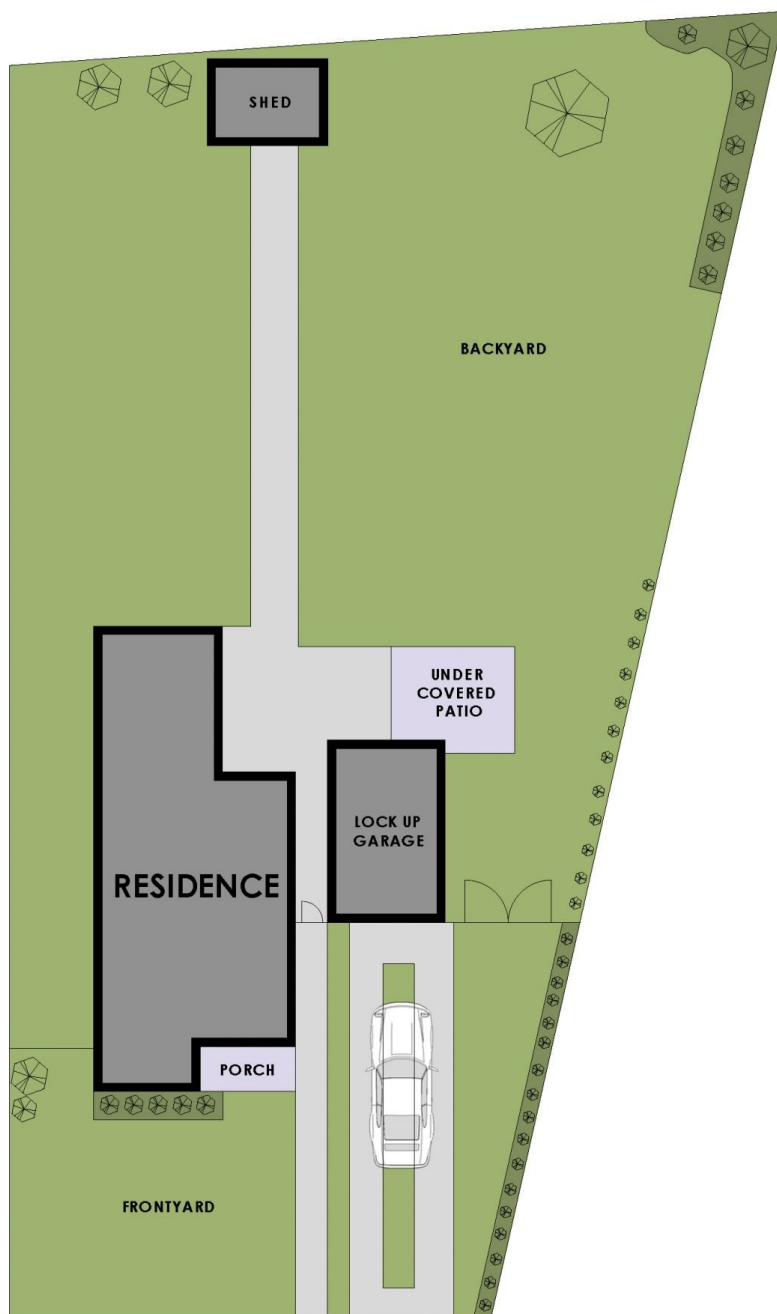

SITE PLAN



STRATHFIELD PARTNERS
REAL ESTATE AGENTS

1395 Canterbury Road, Punchbowl

WARNING: DISCLAIMER This information is not to be relied upon. It is strictly used for marketing and illustration purposes only. All measurements are approximate. Not to scale. No liability accepted. You must rely on your own inquiries and seek advice from your solicitor. Floor plan by cnkplan@cnkplan.com.au / www.cnkplan.com.au