



STRATHFIELD PARTNERS
REAL ESTATE AGENTS



12 Churchill Avenue Strathfield NSW

Modern office/retail spaces situated in the heart of Strathfield within a short stroll from the station.

Conveniently located in the Symond Arcade within Strathfield Plaza, these offices offer an expansive window shop frontage in a security building with heavy foot traffic.

Building Size : 111 sqm
View : <https://www.strathfieldpartners.com.au/lease/nsw/inner-west/strathfield/commercial/retail/7046456>



Fabrizio Pignataro
9704 0018

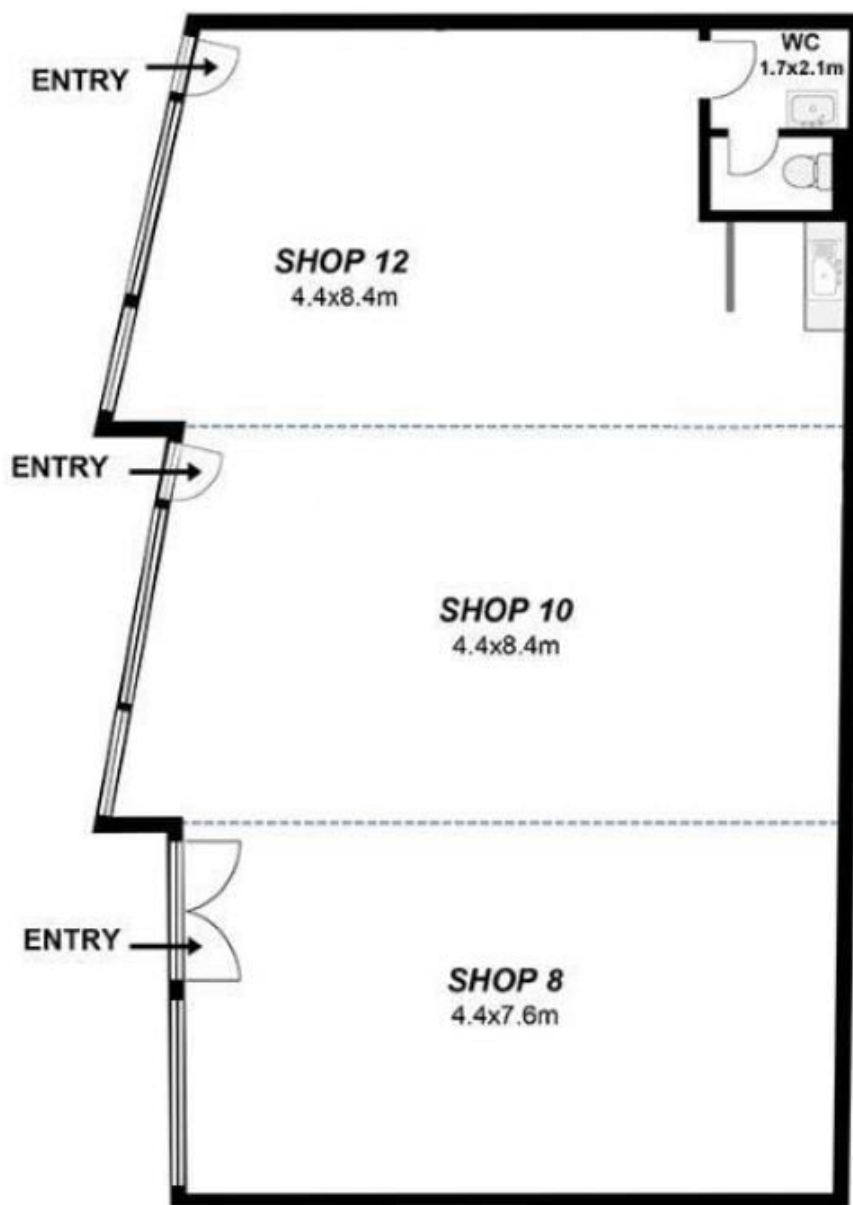

Total Internal Area - approx. 111 Sqm



Shops 8&10&12/12 Churchill Ave Strathfield

Floor plan by DG Life

The following floor plan is shown for presentation purposes only and is not part of any legal document. All measurements and figures are approximate.

