



## 28 Parnell Street Strathfield NSW

Positioned in Strathfield's CBD, this retail opportunity is fit for various uses, including medical, commercial, restaurant, showroom, x-ray use and much more.

Established in Strathfield's superior retail location, features an unprecedented business opportunity like no other for brand-new shopfronts boasting up to 377 sqm with terrace/courtyard and basement parking. These shops are carefully constructed to stand out effortlessly and attract maximum customer exposure.

Offering a fantastic floor plan with generous space and indoor/outdoor seating areas, it is enviably located in a highly sought-after location, rest assured you have all the best amenities at your doorstep readily available for use. Look no further than these flawless retail spaces ready to be occupied.

**Building Size** : 377 sqm  
**Land Size** : 377 sqm  
**View** : <https://www.strathfieldpartners.com.au/lease/nsw/inner-west/strathfield/commercial/retail/7437900>



**Robert Pignataro**  
9763 2277

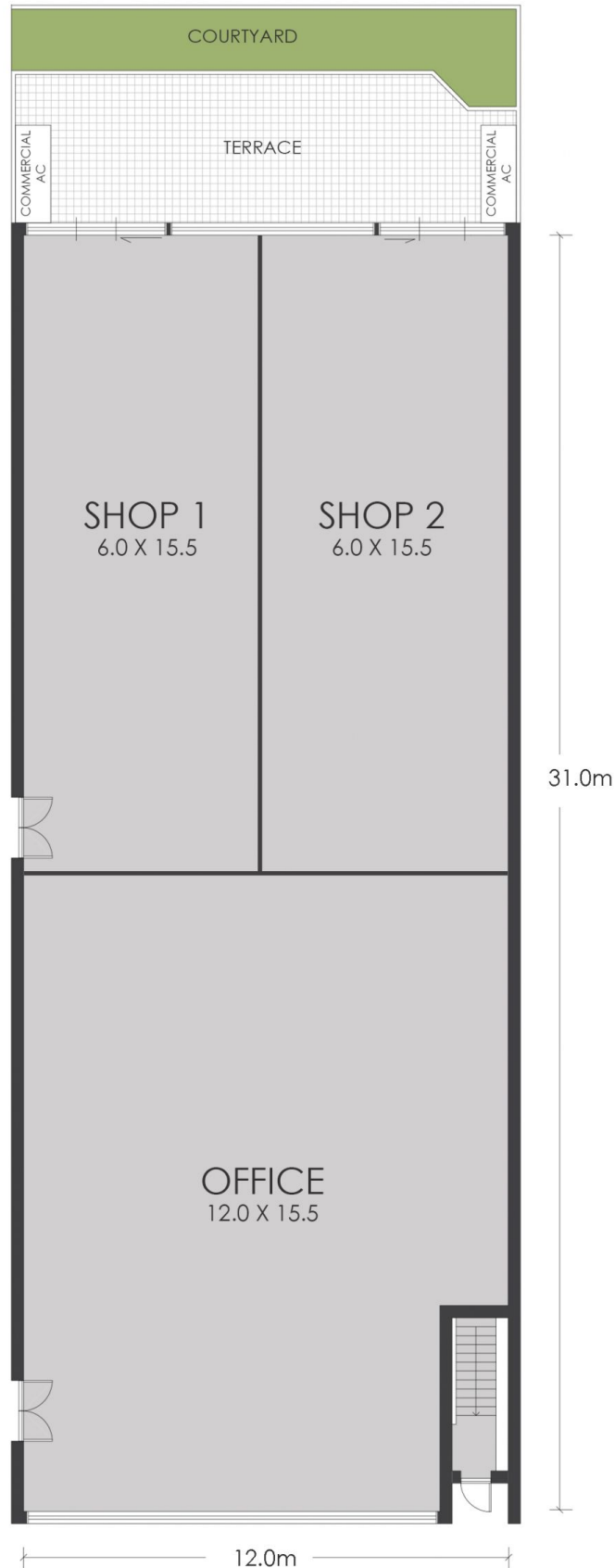

## FLOOR PLAN

### APPROX. AREA SIZE

Internal area 370.0 sqm



**STRATHFIELD PARTNERS**  
REAL ESTATE AGENTS

# 28 Parnell Street, Strathfield

**WARNING: DISCLAIMER** This information is not to be relied upon. It is strictly used for marketing and illustration purposes only. All measurements are approximate. Not to scale. No liability accepted. You must rely on your own inquiries and seek advice from your solicitor. Floor plan by [cnkplan@cnkplan.com.au](mailto:cnkplan@cnkplan.com.au) / [www.cnkplan.com.au](http://www.cnkplan.com.au)