



STRATHFIELD PARTNERS
REAL ESTATE AGENTS



28 The Boulevard Strathfield NSW

Seize this incredible opportunity to acquire a prime retail space in the heart of Strathfield, one of Sydney's most vibrant and bustling retail precincts. Boasting excellent exposure to both pedestrian and vehicle traffic, this shop offers an enviable location with easy accessibility and is within walking distance to both Strathfield and Burwood train stations.

Situated in a landmark location in the very heart of Strathfield, this retail space enjoys exceptional street presence and exposure, ensuring maximum visibility for your business. Surrounded by popular cafes, shops, and amenities, you'll be ideally positioned to attract heavy pedestrian traffic throughout the day.

The 102 sqm retail space features an inviting retail frontage, perfect for showcasing your products or services

Price : Contact Agent
Building Size : 102 sqm
View : <https://www.strathfieldpartners.com.au/lease/nsw/inner-west/strathfield/commercial/retail/7991517>



Fabrizio Pignataro
9704 0018



Adam Eid
02 9763 2277

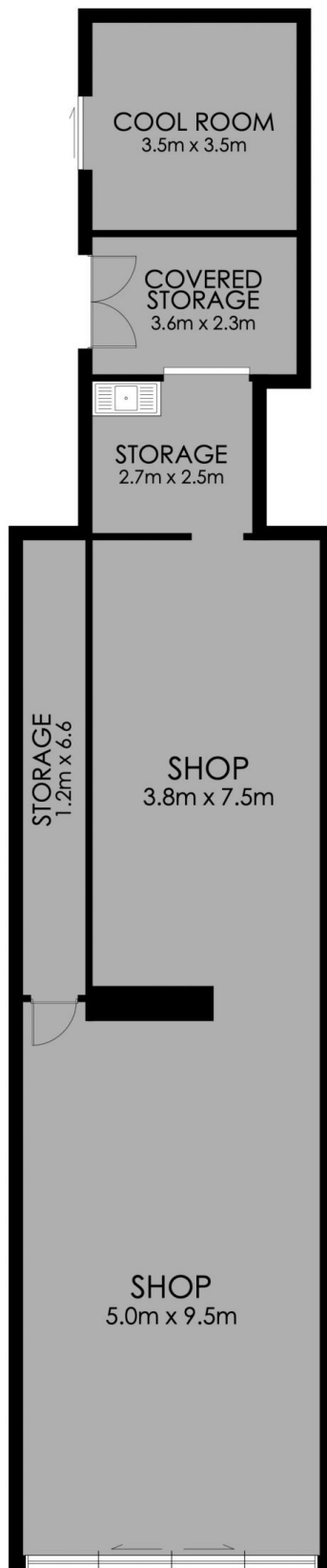

Internal Area: 102 m²



FLOOR PLAN



Shop 28 The Boulevard, Strathfield

WARNING: DISCLAIMER This information is not to be relied upon. It is strictly used for marketing and illustration purposes only. All measurements are approximate. Not to scale. No liability accepted. You must rely on your own inquiries and seek advice from your solicitor.